

Instruction Manual

Swingfog High Performance Thermal Fog Generators

Swingfog devices are provided with protective equipment and have been carefully tested before delivery.

We cannot be held liable for injuries to persons, damage to property and consequential damage if the device is not used or operated in accordance with the provisions of this instruction manual. The instruction manual is included with every device. In addition, a comprehensive manual in English, Spanish, French or German is included with every device.

All regulations that apply to petrol-driven devices must be heeded.



Use only clean containers for filling the fuel tank and the spraying tank.
When refilling fog liquid, always fill up the fuel tank at the same time.



The devices are started via an electronic ignition coil.
Persons with pacemakers may only start the devices after consulting a doctor.



Only start up devices that are free of defects and faults. Do not modify or remove protective devices.



The applicable legal regulations and specifications of the preparation manufacturer must be observed when selecting and using chemical preparations and carrier substances.



The following safety measures must be taken:



Read, understand and heed the instruction manual



Never operate the device unattended



Wear protective clothing



Wear protective gloves



Wear respiratory protection



Wear safety goggles



Use hearing protection



Fire, ignition sources and smoking are prohibited when operating the device



Attention: hot surfaces



Residual amounts of fuel, fog liquid and used batteries must be disposed of in accordance with the legal regulations.



Avoid reaching an explosive concentration when fogging combustible substances indoors. Safety limit:
Output max. 3 l per 1000 m³.
Materials for extinguishing fires must be available.



Devices at operating temperature may not be transported in vehicles (fire hazard).



Prevent tipping over of the device during transport.

For questions, please contact your local supplier or Swingtec GmbH.
E-mail: info@swingtec.de

Swingfog SN 50 - Commissioning

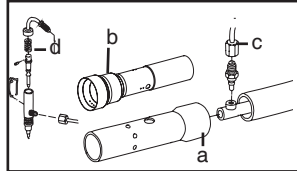
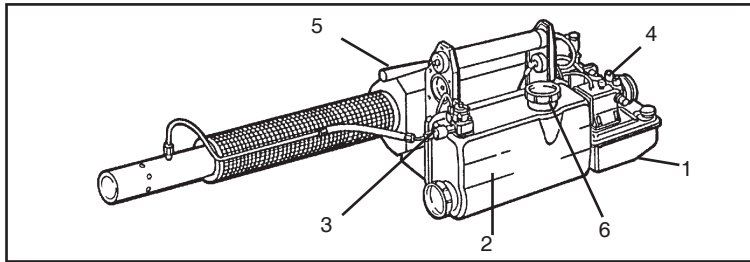

Mount the fog tube according to the drawing. Standard fog tube (a) or high-performance fog tube (for aqueous fog liquids only) (b).

Installation instructions for devices without (c) and with automatic cut-off device for the fog liquid (d).

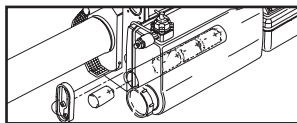

Install the batteries according to the drawing (4 x 1.5 V mono/type D).

- Fill the fuel tank (1) completely
- Fill the spraying tank (2)

Device start

- Close the valve (3) for the fog liquid
- Fully open the red stop button/petrol tap (4)
- Start the device by pumping evenly (5)
- Briefly let the device warm up after starting
- Open the valve (3) for the fog liquid. The device fogs.

Automatic cut-off device for the fog liquid

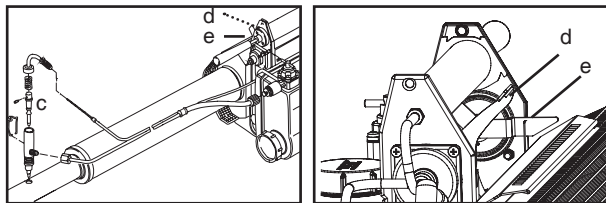

For devices equipped with an automatic cut-off device for the fog liquid (c), fogging is switched on by lifting the operating lever (d) and/or by locking it by means of the securing lever (e). If flammable preparations and/or carrier substances are used, a device equipped with the safety element automatic cut-off for the fog liquid must be used.

If the device stops suddenly (e.g. due to a lack of fuel or improper operation or malfunction) the fogging function switches off automatically with immediate effect.

For devices without an automatic cut-off for the fog liquid, the following immediate measures must be taken if the device stops suddenly (e.g. due to lack of fuel or incorrect operation or malfunction):

- Close the fog liquid valve (3)
- Face the device downwards



For mobile use, wear a shoulder strap and guide the fog to behind you. The tank side must face your body. For stationary use, position the device horizontally and secure it against falling over.

Do not touch heat conducting parts.

Device stop

- Close the fog liquid valve (3) and briefly keep the device running until no more fog emerges.
- Close the red stop button/petrol tap (4).
- Decompress the spraying tank by loosening the fuel cap (6) and then retighten the fuel cap.

Swingfog SN 81 - Commissioning

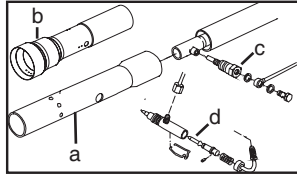
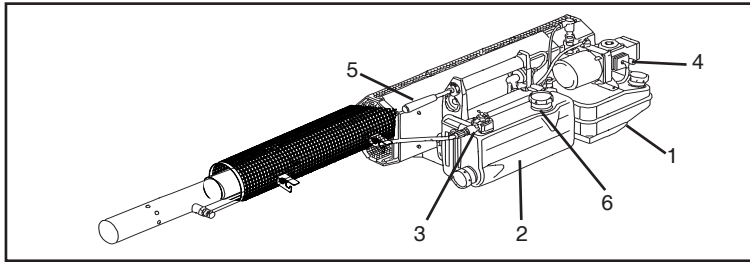

Mount the fog tube according to the drawing. Standard fog tube (a) or high-performance fog tube (for aqueous fog liquids only) (b).

Installation instructions for devices without (c) and with automatic cut-off device for the fog liquid (d).

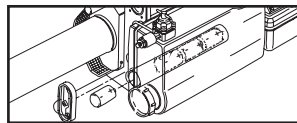

Install the batteries according to the drawing (4 x 1.5 V mono/type D).

- Fill the fuel tank (1) completely
- Fill the spraying tank (2)

Device start/stop

Closely follow the instructions for the Swingfog SN 50.



The explanations provided for the automatic cut-off device for the fog liquid and for mobile or stationary use of the device are based on the Swingfog SN 50 instructions.

The Swingfog SN 81-20 is always supplied with an automatic cut-off device for the fog liquid.

Swingfog SN 101 M - Commissioning

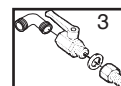
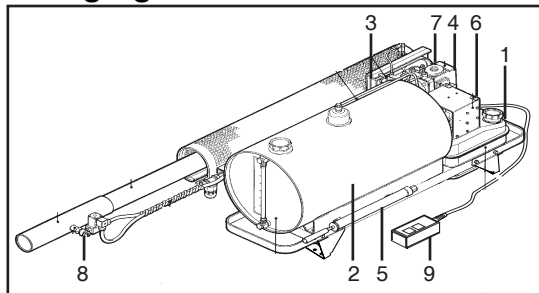

Fog liquid valve
Figure shows the open position. 90° turning to the right: Closed position

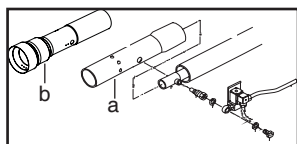

Mount the fog tube according to the drawing. Standard fog tube (a) or high-performance fog tube (for aqueous fog liquids only) (b).

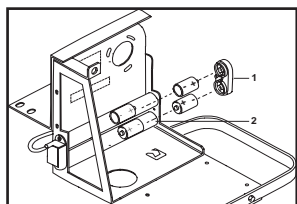

Install the batteries according to the drawing (8 x 1.5 V mono/type D).

Device start

Operating instructions (1), (2), (4) and (5) according to Swingfog SN 50.

- Open the fog liquid valve (3)

Fogging:

- Press the "Fog ON" push button - the device fogs.
- Press the "Fog OFF" push button - fogging stops.
- The push buttons are located on the side of the switch box (6) facing the carburettor (7).

Device stop

- Operating instructions (3) and (4) according to Swingfog SN 50.
- The spraying tank is automatically decompressed.



The device is equipped with an electromagnetic cut-off (8) for the fog liquid. If the device stops suddenly (e.g. due to a lack of fuel or improper operation or malfunction), the fogging function switches off automatically with immediate effect.



The device must be positioned horizontally and safeguarded against falling over during mobile or stationary use. Do not touch heat conducting parts.



The "Fog ON" and "Fog OFF" functions can also be operated via a remote control (9) (optional accessory).

Swingfog SN 101 E - Commissioning

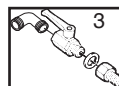
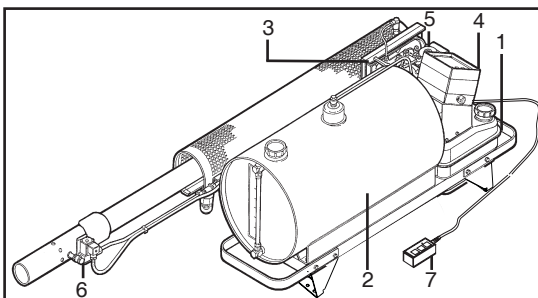

Fog liquid valve
Figure shows open position. 90° turning to the right: Closed position

- Mount the fog tube according to Swingfog SN 101 M drawing and description.

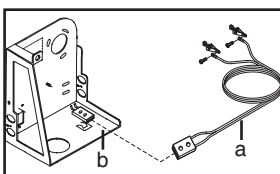

Power supply according to drawing by connecting the battery cable (a) to the coupling (b) and to the **12 volt** battery of the transport vehicle or a separate 12 volt vehicle battery.



Connecting to a 24 volt battery is prohibited.

- Fill the fuel tank (1) completely
- Fill the spraying tank (2)

Device start

- The device and the fogging function are actuated electrically via push buttons on the control panel (4).
- Close the fog liquid valve (3)

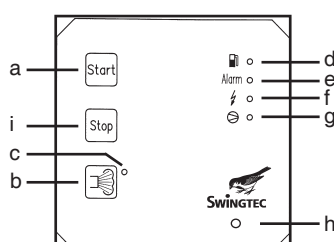

- Press start button (a) - device starts
- Open the fog liquid valve (3)
- Press fog button (b)
The fog button has the functions "Fog ON" and "Fog OFF"
- The signal lights indicate the following: (c) Fog on/off, (d) fuel supply on, (e) error message, (f) ignition on, (g) start air compressor on, (h) device is ready to fog

Device stop

- Close the fog liquid valve (3).
- Press the stop button (i).
- The spraying tank is automatically decompressed.
- The device can also be switched off by pressing the red stop button (5) on the carburettor.



The device is equipped with an electromagnetic cut-off (6) for the fog liquid. If the device stops suddenly (e.g. due to a lack of fuel or improper operation or malfunction), the fogging function switches off automatically with immediate effect.



The device must be positioned horizontally and safeguarded against falling over during mobile or stationary use. Do not touch heat conducting parts.



All device functions can also be operated via a remote control (7) (optional accessory).

Swingfog SN 81 Pump - Commissioning

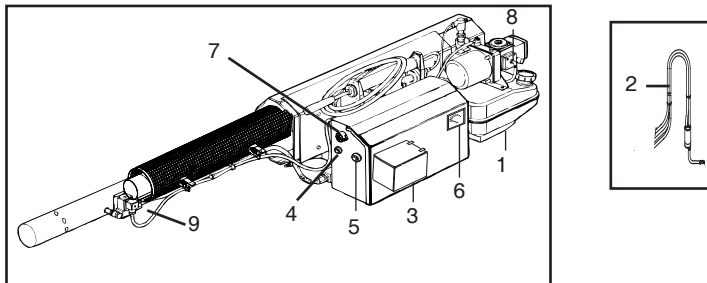

- Mount the fog tube according to Swingfog SN 101 M drawing and description.
- Install the batteries according to Swingfog SN 81 drawing (4 x 1.5 V mono/type D).
- Fill the fuel tank (1) completely.
- Fill the spraying tank
The device is not equipped with its own (integrated) spraying tank. The fog liquid is conveyed through a stainless steel pump (2) from a separate tank. We offer spraying tanks with capacities of 69 l (stainless steel), as well as 80 l, 150 l, 300 l and 500 l (polyethylene). All tanks are equipped with a quick coupling for connecting the pump (2) and with a ventilation in the tank cap.
- Connect the stainless steel pump (2) for the fog liquid to the quick coupling of the spraying tank.
- Connect the battery cables to the rechargeable 12 volt, 12 Ah battery (3).

Device start

- Start the device according to the instructions for Swingfog SN 50 points (4) and (5).

Fogging:

- The fogging function is actuated with the "Fog ON" (4) and "Fog OFF/TEST" (5) push buttons.



The battery voltage for operating the pump (2) for the fog liquid must be at least 10 volts. The voltage can be checked by pressing the "Fog OFF/TEST" (5) push button. It is then displayed on the voltmeter (6).

If the voltage drops below 10 volts, the battery (3) must be charged with the battery charger (standard accessory). The charger is connected to the socket (7) and to a 100-240 V / 50/60 Hz power grid.

- Pressing the "Fog ON" (4) or "Fog OFF/TEST" (5) push buttons automatically switches the pump for the fog liquid on or off.

Device stop

- Press the "Fog OFF/TEST" (5) push button.
- Close the red stop button/petrol tap (8).
- Disconnect the battery (3).
- Disconnect the stainless steel pump (2) from the spraying tank.



The device is equipped with an electromagnetic cut-off (9) for the fog liquid. If the device stops suddenly (e.g. due to a lack of fuel or improper operation or malfunction), the fogging function switches off automatically with immediate effect. The pump (2) is switched off at the same time.



The device must be positioned horizontally and safeguarded against falling over during mobile or stationary use.
Do not touch heat conducting parts.

Swingfog SN 101 Pump - Commissioning

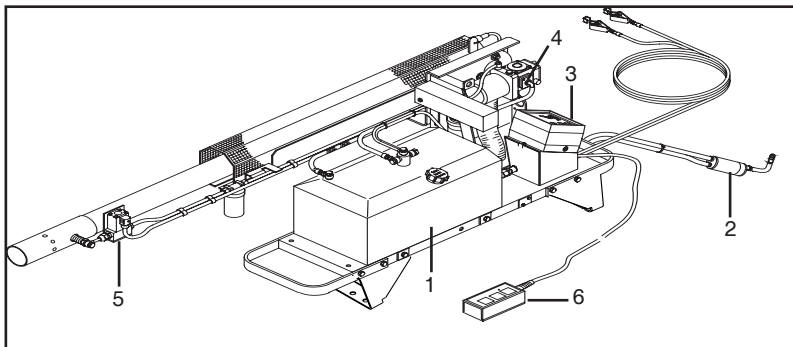

- Mount the fog tube according to Swingfog SN 101 M drawing and description.
- Power supply according to Swingfog SN 101 E drawing and description.
- Fill the fuel tank (1) completely. The tank has a capacity of approx. 21 l and suffices for a fogging duration of approx. 4.5 hours.
- Fill the spraying tank
The device is not equipped with its own (integrated) spraying tank. The fog liquid is conveyed through a stainless steel pump (2) from a separate tank. We offer spraying tanks with capacities of 69 l (stainless steel), as well as 80 l, 150 l, 300 l and 500 l (polyethylene). All tanks are equipped with a quick coupling for connecting the pump (2) and with a ventilation in the tank cap.
- Connect the stainless steel pump (2) for the fog liquid to the quick coupling of the spraying tank.

Device start

- The device and the fogging function are actuated electrically via push buttons on the control panel (3).

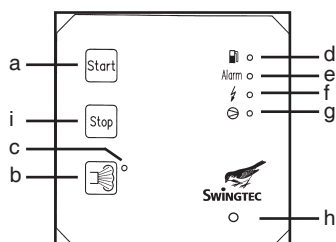

- Press start button (a) - device starts
- Press fog button (b)
The fog button has the functions "Fog ON" and "Fog OFF"
The spraying pump is automatically switched on or off
- The signal lights indicate the following: (c) Fog on/off, (d) fuel supply on, (e) error message, (f) ignition on, (g) start air compressor on, (h) device is ready to fog

Device stop

- Press the stop button (i) on the control panel (3).
- The device can also be switched off by pressing the red stop button (4) on the carburettor.



The device is equipped with an electromagnetic cut-off (5) for the fog liquid. If the device stops suddenly (e.g. due to a lack of fuel or improper operation or malfunction), the fogging function switches off automatically with immediate effect. The pump (2) is switched off at the same time.



The device must be positioned horizontally and safeguarded against falling over during mobile or stationary use.
Do not touch heat conducting parts.



All device functions can also be operated via a remote control (6) (optional accessory).